

	Standard	Possible extras
Technical data:		
Sound insulation:	Rw 39dB* (test result of SP laboratory)	
Fire resistance:	EI30 (single-leaf test result of SP laboratory; double-leaf test result of VTT laboratory)	
Door leaf:		
	Door leaf with thickness 52 ± 1 mm	
Edges:	Vertical edges covered with edge band, horizontal edges unfinished.	
Decoration:	Flush	Door leaf with decorative boards and/or lists
Finish:	White paint (NCS S 0502-Y)	Tinting systems Monicolor, Symphony, Tintorama, RAL, Rautaruuki catalogues. Veneered (oak, pine, teak, birch) + (stain) + lacquere. Veneered (oak, pine, teak, birch) + (stain) + oil. Laminated with high pressure lamination
Gaskets	2 x 10 mm ² fire seal at the passive door leaf	-
Glass opening**	-	According to customer's order and certificate.
Glass	Fireswiss Foam EI30 (15mm)	-
Glazing bead	Wooden, painted. Fixing with screws.	Wooden stained and varnished. Fixing with screws.
Frame:		
	Softwood 42 x 92 mm	Softwood 42 x 92-130
Profile:	"FS435"	"FS435N"
Finish:	Painted white (NCS S 0502-Y)	Tinting systems Monicolor, Symphony, Tintorama, RAL, Rautaruuki catalogues. stained +lacquere stained +oil
Gaskets:	O10 - white White fire seal	O10 - brown Black fire seal
Mounting hole:	Ø 16 mm; white plastic cap	Ø 16 mm; brown or beige plastic cap
Threshold:	Oak 27 mm (type FS/TA-92/...)	27 x 92-130 mm (type FS) 20 x 92-130 mm (type FM) Mechanical threshold Planet FT
Locking system:		
	Lock case: Striking plate:	Lock case: Striking plate:
	565 2863-6***	ASSA 565 1887-5
	Passive door leaf is locked with Abloy DF3000 espagnolette.	ASSA 2002 1887-5
		ASSA 8765 1887-5
		Abloy 4190 or LC100 4691
		Abloy LC190 LP731
Hinges:		
	Abloy NTR 110-30TSS zn	Abloy NTR 110-30TSS (PKU, PKE, CR)
Dimensions:		
	Single-leaf: M7 x 21 M8 x 21 M9 x 21 M10 x 21	Size reduction is permitted Size increase is permitted up to 15% in height and 15% in width, but not more than 20% in area.****
Ironmongery:		
		Kick plate RST (polished, brushed) Dooreye Doorbell Abloy DF64 Extra security lock Door closer Abloy DC405 Postbox Swedbox or Primo31) Cable in tube + transfer

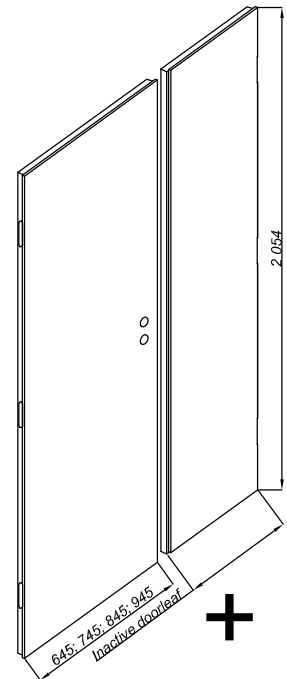
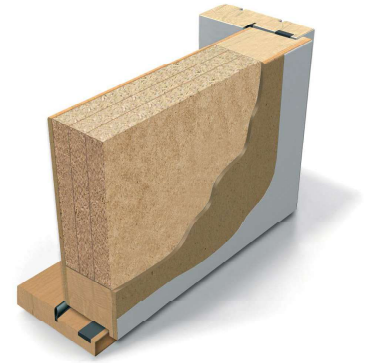

* - Sound insulation is measured for single-leaf door without ironmongeries and glass opening.

** - Glass opening is not permitted for double-leaf door

*** - Do not use as public doors.

**** - Size increase is not permitted for doorsets incorporating glazing and for double doors if post box is included.

Inspecta
Vastavussertifikaat
ET-0055-13

Tule- ja helitökke puituks FD09

EI 30
Rw 39dB

AS Viljandi Aken ja Uks
VILJANDI 

2013
ID: 12345-1

Inspecta
Vastavussertifikaat
ET-0055-13

Tule- ja helitökke puituks FD09

EI 30

AS Viljandi Aken ja Uks
VILJANDI 

2013
ID: 12345-1

Inspecta
Vastavussertifikaat
ET-0109-13

Tule- ja helitökke puituks FD09

EI 30

AS Viljandi Aken ja Uks
VILJANDI 

2013
ID: 12345-1